

Some nappy folds

All pins should run from side to side; remember to tuck the nappy up under the baby's thigh. This eliminates leg restriction and leakage.

TRIANGLE

Fold nappy in half to make a triangle. Fold again to make a smaller triangle. Only one fastener required. Best for a small baby. As baby grows, fold only once.

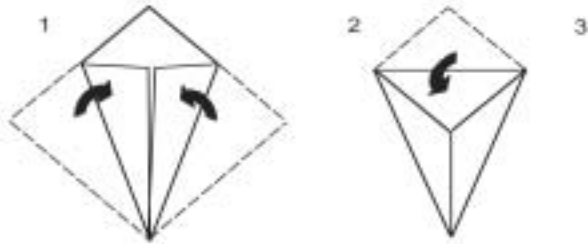
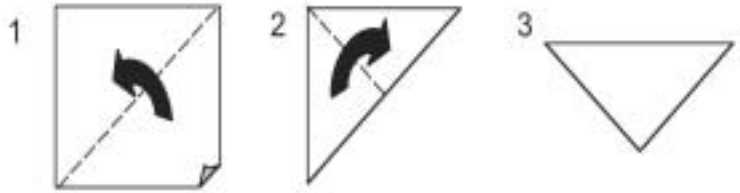

TRIANGLE VARIATION

Fold nappy in half. Fold top edge down (amount folded down will depend on baby's size.) One pin in the front will suffice. Good for smaller babies.

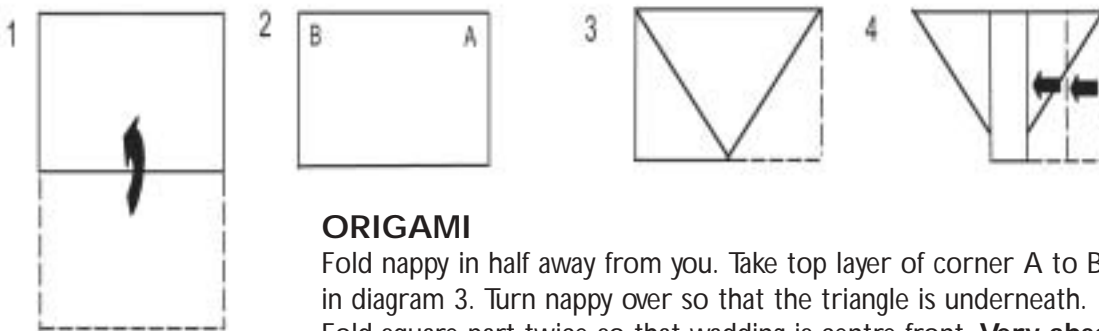

KITE

Fold side flaps to the centre. Fold top down. Fold bottom corner up. Two fasteners will be needed. Better for older babies.

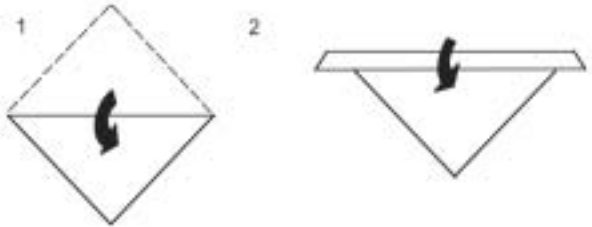

ORIGAMI

Fold nappy in half away from you. Take top layer of corner A to B, making a triangle as in diagram 3. Turn nappy over so that the triangle is underneath. Fold square part twice so that wadding is centre front. **Very absorbent**

NITEKITE

Using 2 nappies, fold the 1st as per diagrams 1 & 2. Then place it on the other nappy and fold the kite fold around it. Two fasteners required. Very good for overnight without the bulk to fasten.

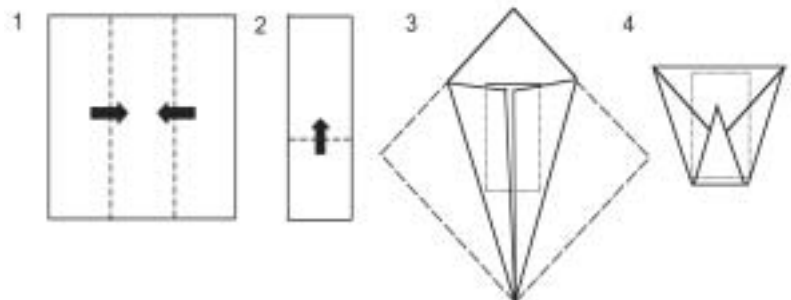

TWIST

Fold the nappy in half as per diagram 1. Take the bottom left corner in your right hand & the bottom right corner in your left hand & uncross your arms. Not meant to hold anything substantial – just to keep the carpet dry while allowing airflow.

